



# Rite-Edge Cor-Ten Lawn and Border Edging

## General Product Information

Designed by landscape architects, the multi award-winning Rite-Edge products are increasingly specified in professional landscape designs as the obvious edging for lawns, borders, beds, roof designs and pathways.

Due to the growing popularity of the rusty finish, we have now introduced an edge made from Cor-Ten Steel. The name COR-TEN refers to the two distinguishing properties of this type of steel: corrosion resistance and tensile strength.

The Cort-Edge can be used for the edging of various soft and hard landscaping materials. It offers a clean separation between garden beds, grass, paths and driveways, creating a pristine appearance and saving hours of maintenance time in your landscape or garden.

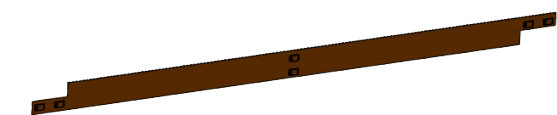

## Product Specification

Material	Cor-Ten steel
Material Height	10cm and 15cm
Thickness	1.5mm with safe top of 3mm
Length	2.385m – 2.23m useful length
Weight	2.8kg/pc for 10cm ; 4.1kg/pc for 15cm
Fixing stakes per piece	3 stakes per edging
Length of fixing stakes	28cm long for 10cm; 38cm long for 15cm
Weight of stakes	60g/stake for 10cm; 82g/stake for 15cm
Pieces per pack	9pcs for 10cm; 6pcs for 15cm
Fixing method	Easy connection with stakes - overlap

## Product Benefits

The Rite-Edge design and product specifications result in an edge which is superior in terms of ease of installation, strength and safety.

- **Amazing Design:** The desirable orange-brown colour that Cor-Ten steel develops over time blends beautifully into all outdoor spaces. This rusty colour and texture goes well with stone, wood, plants, and other outdoor elements.
- **Ease of Installation:** Due to the ease of the male-female joining system, the edge is easy and fast to install. The packaging is below 25kg, making it ergonomical to carry around.
- **Strength:** The edge is reinforced on 3 different points. Stakes will go through these 3 points and are fastened in the ground with the stake ending up 2.5x deeper than the edge itself.
- **Safety:** By folding the top of the edge, a curl- and safe top design is created, avoiding potential cuts to hand or feet caused by any sharp edges in your landscape or garden